

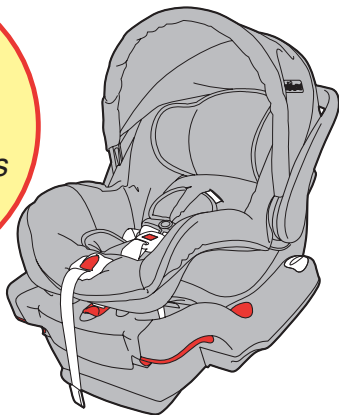

KeyFit™ Base



**READ USER
GUIDE**
*before using this
infant restraint*



User Guide

*For future use, STORE USER GUIDE
in door at rear of Base.*

TABLE OF CONTENTS

Safe Use Checklist	4
Registration & Recall	5
Assistance	5
Warnings	6
Base Features	
Base Overview	12
Storage Compartment	13
Recline Adjustment	13
UAS Removal & Storage.....	14
Shoulder Belt Lockoff.....	15
Vehicle Information	
Unsafe Vehicle Belts.....	16
Installation Positions	17
Installation with Base	
UAS or Vehicle Belt?	18
Installation Using Vehicle Belt	18
Installation Using UAS.....	20
Uninstalling Base	19, 22
Cleaning and Maintenance	23
Replacement Parts	23

SAFE USE CHECKLIST

⚠ YOUR INFANT'S SAFETY DEPENDS ON YOU!

You MUST follow the detailed instructions in this User Guide to ensure the steps below are performed correctly!

1 Install Infant restraint system Rear-Facing

- ☐ forward facing vehicle seats only
- ☐ infant faces towards rear of vehicle

1



2 Install in Safe Location in Vehicle

- ☐ position with NO Frontal air bag
- ☐ compatible vehicle belts

2



3 Ensure Infant is in Size Range

- ☐ weight – 1.8 - 13.6 kg (4-30 lbs)
- ☐ height – 76 cm (30 inches) or less or top of head is at least 2.54 cm (1 inch) below the top of the seat back

3

4

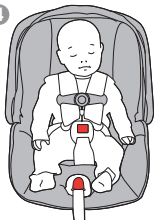

4 Secure Infant Properly in Carrier

- ☐ correct shoulder strap height
- ☐ harness snug and chest clip correct

5

5 Secure Infant Restraint System Properly in Vehicle

- ☐ vehicle belts tight and infant restraint system is secure
- ☐ Carrier securely attached to Base

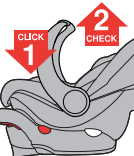

6 Verify that Recline Angle is Correct

- ☐ bubble between arrows
- ☐ level Line on Carrier is level with ground

6

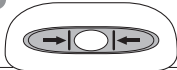

REGISTRATION & RECALL

Please complete the Registration Card that came with your Infant restraint system and mail it promptly or register online at: **www.chicco.ca**

Infant restraint systems could be recalled for safety reasons. You must register this infant restraint system to be reached in a recall. Send your name, address, and the infant restraint system's model number and manufacturing date to:

ISSI Inc.
4500 THIMENS BLVD, SUITE 100
SAINT-LAURENT (QC) H4R 2P2
or call 1-800-667-4111 or 514-344-3045

or register on-line at www.chicco.ca.

For recall information, call 1-800-667-4111

NEED HELP?

If you have any problems with your Chicco Infant restraint system, or any questions regarding installation or use, please call:

ISSI Inc. Customer Service
1-800-667-4111 or 514-344-3045
or email us at service@chicco.ca

*Please have Model and Serial Number available when you call.
These are located on a label on the bottom of the Child Restraint.*



Take Time to Read This User Guide

⚠ Carefully read and understand all instructions and warnings in this User Guide. Your infant's safety depends on you knowing how to setup, install and use this infant restraint system properly.

⚠ Before installing this infant restraint system in a vehicle, be sure to also check the vehicle owner's manual for information on infant restraint system installation.

⚠ NEVER allow others to use this infant restraint system until they have read and understood all instructions in this User Guide. For future reference, keep this User Guide in storage door at rear of Base.

Make Sure Infant Fits This Infant Restraint System

⚠ ONLY USE this infant restraint system with infants who weigh between 1.8 and 13.6 kg (4 and 30 lbs) and whose height is 76 cm (30 inches) or less.

⚠ DO NOT use this infant restraint system if top of infant's head is less than 2.54 cm (1 inch) from top of restraint.

⚠ ONLY USE the Newborn Insert in the lowest harness position, and only if the infant weighs between 1.8 and 5 kg (4 and 11 lbs).

⚠ DO NOT use Newborn Insert if infant weighs more than 5 kg (11 lbs).

WARNING

Secure Infant Properly

 Snugly adjust the harness around your infant. A loose harness could cause the infant to be ejected in a sudden stop or crash, resulting in serious injury or death.

A snug strap should not allow any slack. It lies in a relatively straight line without sagging. It does not press on the infant's flesh or push the infant's body into an unnatural position.

 **NEVER** use clothing or blankets that interfere with fastening or tightening the harness. An unsecured infant could be ejected in a sudden stop or crash!

*To keep infant warm, place a blanket over infant and infant restraint system **AFTER** you have properly secured infant in harness.*

 **ALWAYS** check to make sure buckle is securely latched. If buckle separates, infant could be killed or seriously injured.

 **NEVER** leave infant unattended.

 **ALWAYS** keep infant properly secured in harness whenever infant is in Carrier.

WARNING

Install Infant Restraint System Correctly

⚠ NEVER place this infant restraint system in a vehicle position that has a frontal air bag.

An infant in a rear-facing infant restraint system could be killed by an air bag. Refer to vehicle owner's manual before installing this infant restraint system in a seating position with side air bags.



⚠ ALWAYS install rear-facing when using this infant restraint system in a vehicle. Your infant could be killed or seriously injured if you install this infant restraint system forward facing.

⚠ Install this infant restraint system in a rear vehicle seat if possible.

According to accident statistics, children are safer when properly restrained in the rear seating positions rather than in the front seating positions.

⚠ ONLY install this infant restraint system in forward facing vehicle seats.

⚠ NEVER install in rear facing or side facing vehicle seats.

⚠ NEVER install on the back of a folded down vehicle seat.

⚠ NEVER use infant restraint system in a vehicle seating position where it can not be secured tightly. A loosely installed infant restraint system will not protect your child in a crash.

WARNING

Install Infant Restraint System Correctly

⚠ ALWAYS secure this infant restraint system with the vehicle's infant universal anchorage system (UAS) if available or with a vehicle belt.

Never use both at the same time.

To ensure a correct installation of infant restraint system, you must follow the step by step instructions in this User Guide.

⚠ BEFORE each use, **ALWAYS** check to make sure infant restraint system is tightly secured in the vehicle seat.

⚠ ALWAYS check for secure attachment of Carrier each time you use this infant restraint system. After latching Carrier into Base, lift up on Carrier to make sure that it is securely attached to Base. Infant could be killed or seriously injured if Carrier is not securely latched to Base.

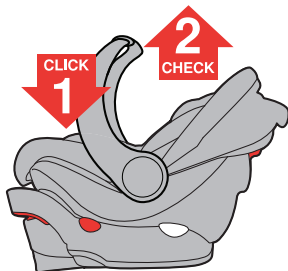

⚠ NEVER travel with this infant restraint system unsecured in a vehicle, even when it is unoccupied. An unsecured infant restraint system could injure other occupants in a sudden stop or crash.

⚠ ONLY use Chicco KeyFit and KeyFit 30 infant restraints with Chicco KeyFit bases.



Ensure Infant's Safety When Using Carrier

⚠ NEVER Leave Infant Unattended!

⚠ Suffocation Hazard: Infant Carrier can roll over on soft surfaces and suffocate infant. NEVER place Carrier on beds, sofas or other soft surfaces.

⚠ Strangulation Hazard: Infant can strangle in loose Infant restraint system straps. ALWAYS use harness. NEVER leave infant in Carrier when straps are loose or undone.

⚠ Fall Hazard: Infant's movements can slide Carrier. NEVER place Carrier near edges of counter tops, tables, or other elevated surfaces. Infant and Carrier might fall.

⚠ BE SURE handle is locked in the "carry position" before lifting Carrier by handle. An unlocked handle could move unexpectedly, causing injury to infant.

⚠ NEVER place Carrier in top of shopping cart. Carrier will not be secure and could fall causing injury to infant.

⚠ ALWAYS check buckle and other parts for hot surfaces. A hot surface could burn infant! Cover unoccupied Carrier with blanket when leaving in a vehicle exposed to sunlight.



Check Condition of Infant Restraint System

⚠ DO NOT use this Infant restraint system if any of the Harness or UAS straps are cut, frayed or damaged in any way.

⚠ DO NOT use this infant restraint system if any parts are broken, damaged or missing. Call 1-800-667-4111 or 514-344-3045 to find out if the damaged part or parts can be replaced.

⚠ DO NOT use this Infant restraint system longer than 6 years from manufacture date or date of purchase (proof of purchase required). Please keep a copy of the receipt with this user guide for your records and for future reference. "Manufacture Date" can be found in 2 locations, on the underside of carrier and in the recess of base.

⚠ YOU MUST replace this infant restraint system if it has been involved in a crash, even if you cannot see visible damage. A damaged infant restraint system may not protect your infant in a future crash.

Modifications and Accessories

⚠ NEVER modify or disassemble this infant restraint system except as instructed to in this User Guide.

⚠ DO NOT use any accessories, pads or products not included with this infant restraint, unless specifically approved by Chicco. Doing so will void the warranty of this infant restraint system. Items not tested with this infant restraint system could injure your infant.

BASE OVERVIEW

- a** Recline Foot
- b** Recline Button
- c** Recline Indicator
- d** UAS Connector
- e** UAS Release Lever
- f** UAS Pull Strap
- g** Shoulder Belt Lockoff
- h** Carrier Attachment Hook
- i** Pull Strap Storage Pocket
- j** Storage & User Guide

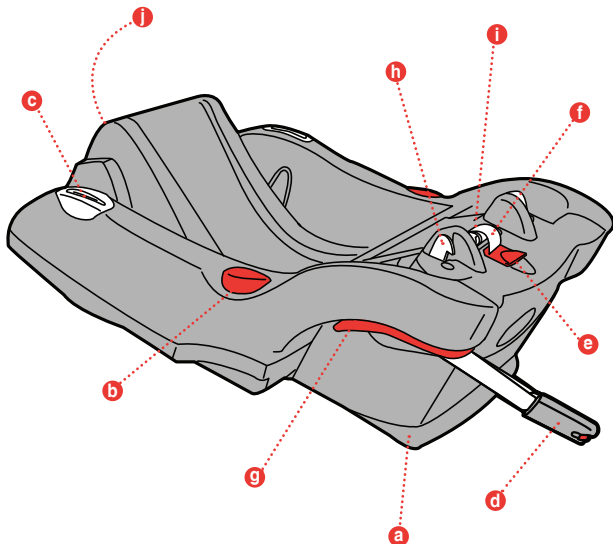

BASE FEATURES

Storage Compartment

The Storage Compartment is at the rear of the Base. The User Guide is stored in the Door.

⚠ DO NOT place heavy or sharp items in the Storage Compartment. They could fly out during a sudden stop or crash, and cause serious injury.

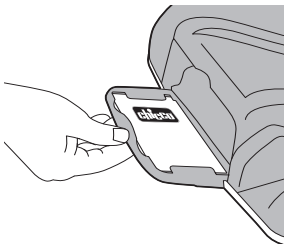

Recline Adjustment

① Recline angle may be adjusted by pushing Recline Buttons while lifting Base.

② Angle is correct when entire Bubble is between arrows.

Vehicle MUST be on a level surface for the Bubble to indicate correctly.

If vehicle is not on a level surface, check the level line on the carrier. It must be level with the ground.

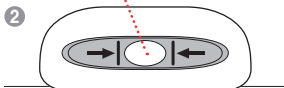
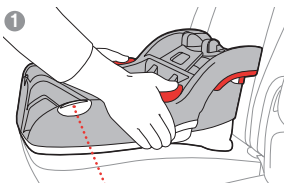

UAS REMOVAL & STORAGE

This infant restraint system can be safely installed using vehicle belts or UAS. UAS is a Infant restraint system attachment system that is standard in most vehicles manufactured after September 1, 2002. Refer to your vehicle owner's manual for details regarding UAS use in your vehicle.



Removing UAS

Pull UAS Connectors out of storage pockets while lifting up on UAS Release Lever.

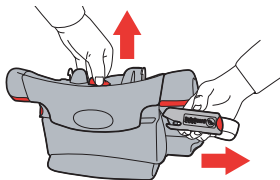

Storing UAS:

1 Insert UAS Connectors into storage pockets.

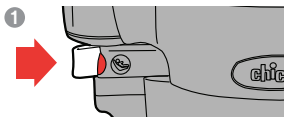

2 Pull UAS Pull Strap to secure UAS Connectors.

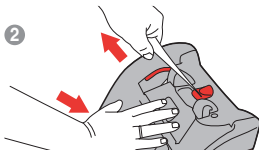

3 Roll UAS Pull Strap and store in Pull Strap Storage Pocket.



⚠ When not using UAS, the UAS Connectors and Pull Strap MUST be stored properly to allow Carrier to attach securely to Base.

SHOULDER BELT LOCKOFF

The Shoulder Belt Lockoff (diagonal belt) is used when installing the Base using your vehicle belts. It locks the vehicle shoulder belt in place, ensuring a stable, secure Base installation.

Do not put the shoulder belt in the locked mode before installing and using the Shoulder Belt Lockoff.

1 With vehicle belt tight, position the Shoulder belt under the Shoulder Belt Lockoff that is on the opposite side of the buckle. Do not pull belt to tighten when belt is in the Shoulder Belt Lockoff. Applying too much pressure to the Lockoff can damage it.

2 Firmly slide shoulder belt into the lockoff.

(Optional: Once the base is installed tightly, the shoulder belt can be put in the locked mode. See vehicle owner's manual or label on seat belt for more information.)

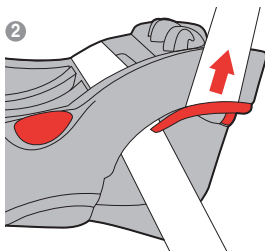
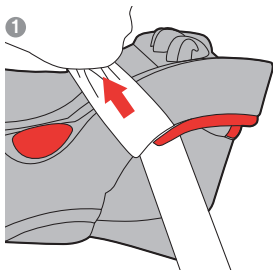

Refer to "Installation Using Vehicle Belt" on page 18 for detailed installation instructions.

VEHICLE INFORMATION

This infant restraint system can only be used in the following types of vehicles: Multi Purpose Passenger Vehicle, Passenger Car and Trucks.

This infant restraint system can be securely installed in most vehicles using the vehicle seat belts or UAS. BUT, there are some vehicle belts and installation positions that are UNSAFE for use with this infant restraint system.

Refer to your Vehicle Owner's Manual for detailed information about vehicle belts, UAS, and preferred infant restraint system installation positions.

UNSAFE Vehicle Belts

The following types of vehicle belts MUST NOT be used to install this Infant restraint system:

- 1 Motorized (automatic) vehicle belts.
- 2 Door mounted vehicle belts.
- 3 Lap/Shoulder Belts with 2 retractors, (unless Lap Belt has a "Lock Mode").
- 4 Non-Locking (ELR) Lap Belts. (Emergency Locking Retractors)

*1 retractor tensions the Lap Belt and
1 tensions the Shoulder Belt.*

*These belts remain loose after installation
and only lock during a sudden stop or crash.*

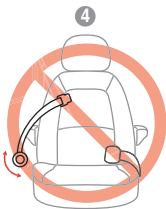
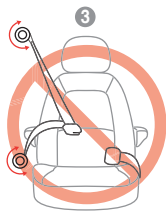
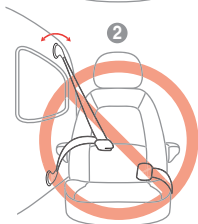

INSTALLATION POSITIONS

Accident statistics indicate that children are safer when properly restrained in rear seating positions than in front seating positions. Children 12 and under should ride in rear seating positions.



The **BEST POSITION** is one that:

- Is Recommended by Vehicle Owner's Manual.
- Results in Secure Installation of infant restraint system.

⚠ ONLY install infant restraint in forward facing vehicle seats. NEVER install in rear or side facing seats or on back of a folded down vehicle seat.



⚠ AIR BAG WARNING:

NEVER install infant restraint system in a seat with a Frontal air bag. **DEATH or SERIOUS INJURY** may occur. Refer to your Vehicle Owner's Manual for Side air bag warnings and information.



INSTALLATION USING VEHICLE BELT

UAS or Vehicle Belt? This Infant restraint system can be safely installed using Vehicle Belts or UAS; never use both. Use the method that results in the MOST SECURE installation in your vehicle.



1 Position Base in forward facing vehicle seat with Recline Foot against seat back.

2 Adjust Base Angle by pushing Recline Buttons while lifting Base. Angle is correct when Bubble is between arrows.

Vehicle must be on a level surface for the Bubble to indicate correctly.

3 Route Vehicle Belt through openings in Base and buckle the vehicle belt.

(Do not put the shoulder belt in locked mode. See page 15 for more information.)

4 Tighten Vehicle Belt while pushing Base firmly into vehicle seat.

5 Secure Vehicle Shoulder Belt firmly under Shoulder Belt Lockoff, while keeping tension on Belt. Only use the lockoff on the opposite side of the buckle.

Caution: Do not pull on shoulder belt when it is in the lockoff.

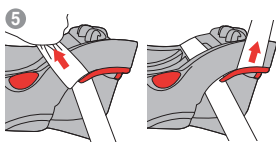
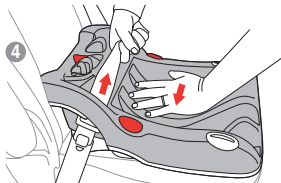
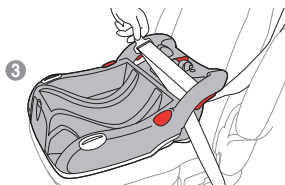

INSTALLATION USING VEHICLE BELT

If using Vehicle Lap Belt only (no Shoulder Belt), make sure that Lap Belt is **LOCKED**, and that free end of Lap Belt is neatly stored so it **DOES NOT INTERFERE** with attachment of Carrier to Base.

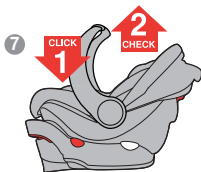
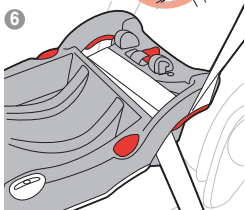
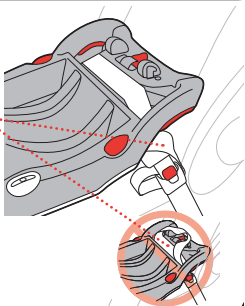

6 CHECK Installation:

- a Belts **MUST** be **TIGHT**.
- b Base **MUST** be **STABLE**.
- c Bubble **MUST** be between arrows.
- d Belts & Buckles **MUST NOT INTERFERE** with attachment of Carrier to Base.

7 **Attach Carrier To Base** after properly securing infant in Carrier.

⚠ **ALWAYS** lift up on Carrier to verify it is properly attached to the Base.

Uninstalling Base:

Remove Carrier from Base, unbuckle Vehicle Belt, and remove Base from vehicle.

⚠ **ALWAYS** place handle in **LOCKED "CARRY"** position when using Infant restraint system in vehicle.

⚠ **NEVER** travel with infant restraint system unsecured in vehicle. Passengers may be injured during a sudden stop or crash.

INSTALLATION USING UAS

UAS or Vehicle Belt? This Infant restraint system can be safely installed using Vehicle Belts or UAS; never use both. Use the method that results in the MOST SECURE installation in your vehicle.



1 Remove UAS Connectors from storage pockets while lifting up on UAS Release Lever.

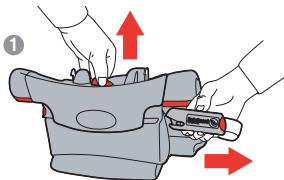

2 Position Base in forward facing vehicle seat with Recline Foot against seat back.



3 Adjust Base Angle by pushing Recline Buttons while lifting Base. Angle is correct when Bubble is between arrows.

Vehicle must be on a level surface for the Bubble to indicate correctly.

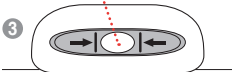

4 Attach UAS Connectors by pushing them firmly onto vehicle UAS Anchor Bars. Verify connection is secure by pulling firmly on UAS straps.

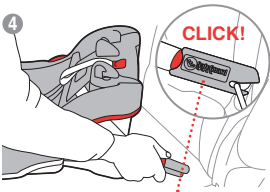

⚠ This infant restraint base is designed to be used with lower UAS anchors at the standard spacing 27.94 cm (11 inches) ONLY! REFER TO VEHICLE OWNER'S MANUAL for information about UAS and infant restraint system installation positions.

INSTALLATION USING UAS

5 Tighten UAS Belts by pulling up firmly on UAS Pull Strap while pressing Base firmly into vehicle seat.

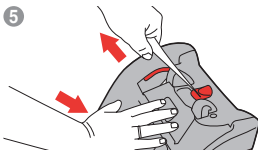

6 Store UAS Pull Strap neatly in Pull Strap Storage Pocket.



7 Check Installation

- a UAS belts MUST be TIGHT**
- b Base MUST be STABLE**
- c Bubble MUST be between arrows**
- d UAS Pull Strap MUST NOT interfere with attachment of Carrier to Base.**

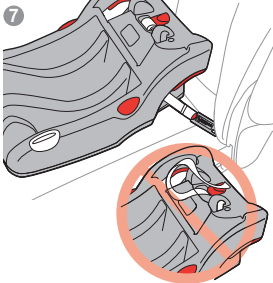

8 Attach Carrier to Base after properly securing infant in Carrier.

⚠ ALWAYS lift up on Carrier to verify it is properly attached to the Base.

⚠ ALWAYS place handle in LOCKED "CARRY" position when using Infant restraint system in vehicle.

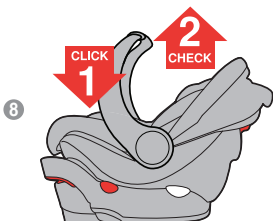

INSTALLATION USING UAS

Uninstalling Base

Remove Carrier from Base

1 Loosen UAS by lifting the UAS

Release Lever and pulling Base away from vehicle seat back.

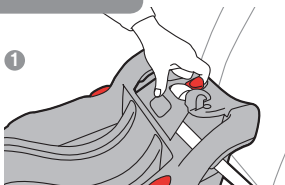

2 Detach UAS Connectors by pressing the red button on each UAS Connector, and remove Base from vehicle.

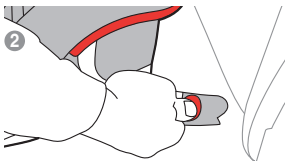

Storing UAS

Insert UAS Connectors into storage pockets. **a**

1 Pull UAS Pull Strap to secure UAS Connectors.

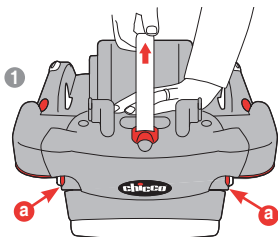

2 Roll UAS Pull Strap and store in Pull Strap Storage Pocket.



⚠ NEVER travel with infant restraint system unsecured in vehicle. Passengers may be injured during a sudden stop or crash. When not using UAS, the UAS Connectors and Pull Strap MUST be stored properly.

CLEANING & MAINTENANCE

⚠ NEVER remove Harness or harness components from Carrier. If harness is extremely soiled or damaged, Call 1-800-667-4111 or 514-344-3045 to order a replacement.

Cleaning Plastics

Sponge clean using warm water and mild soap. Towel dry.

⚠ DO NOT USE BLEACH, solvents, or household cleaners, as they may weaken the plastics.

Cleaning UAS Straps

Sponge clean using warm water and mild soap. Air dry.

⚠ DO NOT USE BLEACH, solvents, or household cleaners, as they may weaken the straps.

Cleaning UAS Hardware

Sponge clean, or rinse in cup of warm water.

⚠ DO NOT USE ANY SOAPS OR LUBRICANTS on UAS Hardware. It may cause them to malfunction.

Replacement Parts

Many replacement parts are available for your Infant restraint system. To order replacement parts, call:

ISSI Inc.

Customer Service

1-800-667-4111

514-344-3045

Please have the infant restraint model and serial numbers available to expedite service.

